

### K. SUBITO® SN for grooves and recesses

The measuring instruments of the series SN serve also for the measurement of grooves and recesses. The retraction of the fixed measuring pin is here smaller than it could be achieved with the series ST, however it is possible to determine also small groove diameters. The basis of this instrument is also the SUBITO®. The range of application goes from 60 up to 300 mm. The calibration of the instrument is effected with a master setting ring. If it is requested to measure a groove only with an accuracy of 1/100, the economical SCHWENK alternative for this is the series ON/ONM. To decide which measuring instrument is suitable for each situation, the following information is needed:

- diameter  $d_1$  (inserting diameter),
- diameter  $D$  (diameter to be measured),
- groove width  $B$ ,
- groove depth,
- measuring depth  $MT$ ,
- accuracy, tolerances

#### technical data SN

range of application	60 - 300 mm
repeatability	$f_w \leq 1 \mu\text{m}$
max. deviation	$f_e \leq 2 \mu\text{m}$
hysteresis	$f_u \leq 2,5 \mu\text{m}$

#### SELECTION CRITERIA FOR SUBITO® SN

Range of application D	mm	mm	mm
from	60	120	180
up to	120	180	300
travel s	1,4	1,6	1,6
measuring depth MT	180	230	230
total length L	295	365	365
retraction travel r	8,5	23	30
tube $\varnothing R$	12	18	18
centring plate width ZB	45	75	120
front distance h	8	10	13
width of groove B	3	4	4

Special measuring designs on request



SUBITO® for recesses and grooves SN

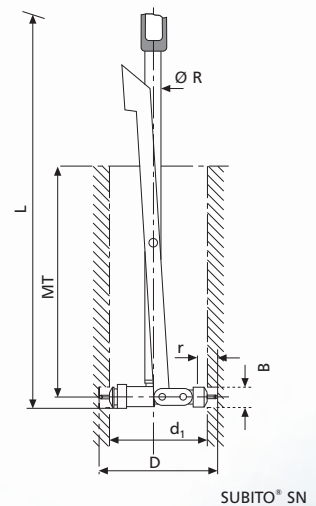

THE VARIANTS