

# SUBITO® Precision Bore Gauge

KT

for measuring reference diameters of internal gears

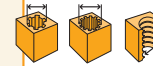

SERIES 160-164

**Delivery:** Holder with contact pin and exchangeable measuring inserts; contact pin and measuring inserts with inside thread to screw in ball inserts; in wooden box, ball inserts to be ordered separately. Measuring instruments for internal gears from diameter 8 mm based on OSIMESS on inquiry.

## SUBITO® KT

Application range M [mm]		Art.-No.
KT	12 8 - 12	160 00000
KT	22 12 - 22	161 00000
KT	55 22 - 55	162 00000
KT	250 55 - 250	163 00000
KT	510 100 - 510	164 00000

## ACCESSORIES KT

Application range M [mm]		Thread	Art.-No.
KT	12 1 Set ball inserts w. tungsten carbide balls of your choice*; ball - Ø d over 0,8 mm up to 2 mm (1 x meas. pin, 1 x ball insert)	M 1,6	160 00001
KT	22 1 Set ball inserts w. tungsten carbide balls of your choice*; ball - Ø d over 0,8 mm up to 4 mm	M 1,6	161 00001
KT	55 1 Set ball inserts w. tungsten carbide balls of your choice*; up to ball - Ø d 7 mm	M 2,5	162 00001
	1 Set ball inserts w. tungsten carbide balls of your choice*; ball - Ø d over 7 mm up to 10 mm		162 00003
	Reducing socket for the use of ball inserts	M1,6/M2,5	162 00032
KT	250 1 Set ball inserts w. tungsten carbide balls of your choice*; up to ball - Ø d 7 mm	M 4	163 00001
and			
KT	510 1 Set ball inserts w. tungsten carbide balls of your choice*; ball - Ø d over 7 mm up to 10 mm		163 00003
	Reducing socket for the use of ball inserts	M4/M 2,5	162 00004
	KT 55 in KT 250/510		

\* Ball inserts with standard ball diameter < 10 mm according to our tungsten carbide ball list on page 30. Deviating intermediate dimensions + 25% extra charge.  
Ball inserts with tungsten carbide ball-Ø ≤ 0,8 mm and ≥ 10 mm on inquiry.



SUBITO® KT with measuring inserts and ball inserts

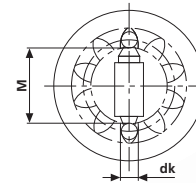

even no. of teeth

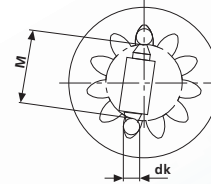

odd no. of teeth

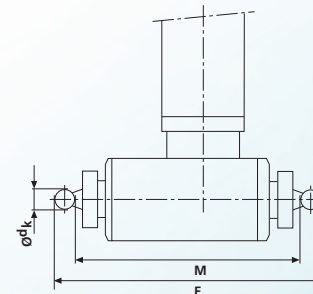

SUBITO® KT dimensions